

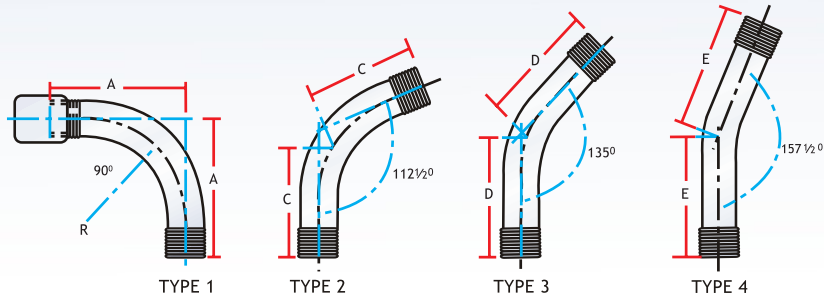

WROUGHT STEEL FITTINGS

Bends and springs Taper threads



Bends

Type 1. These are socketed as illustrated

Springs

These are supplied without sockets unless otherwise ordered. The angle should be stated on enquiries and orders. Springs can be made to any angle required.

Screwing

Screw threads comply with the requirements of SABS1109. (ISO pipe threads for pipes and fittings where pressure-tight joints are made on the threads).

Manufactured from medium and heavy pipe. Available in galvanised, black and steam quality.

NOMINAL BORE mm	BENDS TYPE 1 90°		SPRINGS		
	CENTRE TO FACE MINIMUM A mm	APPROXIMATE RADIUS R mm	TYPE 2 112 1/2°	TYPE 3 135°	TYPE 4 157 1/2°
			CENTRE TO FACE MINIMUM		
	A mm	R mm	C mm	D mm	E mm
6	51	32	48	44	44
8	64	41	60	57	54
10	73	48	67	64	60
15	86	57	79	76	73
20	102	73	92	89	86
25	121	89	108	105	102
32	146	108	133	127	124
40	165	127	149	143	140
50	203	159	181	175	168
65	248	197	222	213	206
80	292	232	260	248	241
100	381	308	340	324	318
125	540	457	476	457	444
150	622	534	572	540	527

Running nipples and barrel nipples

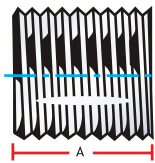

RUNNING NIPPLE - PARALLEL THREAD

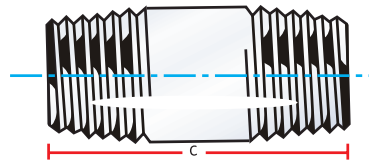

BARREL NIPPLE - TAPER THREAD

Manufactured from medium and heavy pipe. Available in galvanised, black and steam quality.

NOMINAL BORE mm	STANDARD LENGTHS			
	RUNNING NIPPLES		BARREL NIPPLES	
	MINIMUM A mm	TOLERANCE	MINIMUM C mm	TOLERANCE
6	13		32	
8	19		38	+ 3mm
10	21		38	
15	27	+ 1,5mm	51	
20	30		55	+ 4,5mm
25	33		60	
32	38		70	
40	38		70	+ 6mm
50	48		79	
65	51	+ 3mm	89	
80	57		102	
100	70		114	+ 8mm
125	78		124	
150	78		127	



WROUGHT STEEL FITTINGS

Sockets Screwed BSP thread

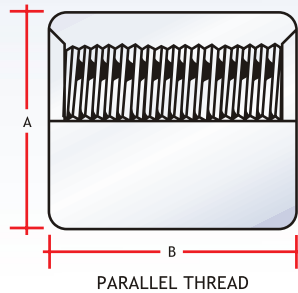

NOMINAL BORE mm	OUTSIDE DIAMETER A - mm - min	LENGTH * B - mm - min	MASS kg
6	14,0	19	0,017
8	17,5	27	0,035
10	21,7	28	0,046
15	25,5	36	0,081
20	31,0	38	0,107
25	38,7	45	0,170
32	47,3	50	0,261
40	53,4	50	0,317
50	66,5	58	0,494
65	82,4	67	0,734
80	96,4	73	1,173
100	123,0	85	1,768
125	151,0	92	2,774
150	178,0	92	3,841

* Not applicable to faced sockets (see Longscrews).

Longscrews

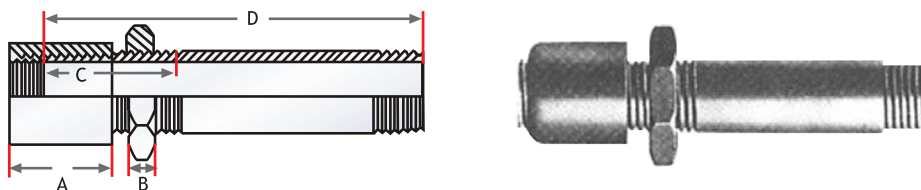

Available with steel sockets and with or without malleable iron backnuts as required.
NOTE: The tolerance on widths across flats of backnuts shall be plus minus 0,8mm.

NOMINAL BORE mm	FACED SOCKET		MALLEABLE IRON HEXAGON BACKNUT			MIN. EFFECT LENGTH OF LONG THREAD mm	STANDARD LENGTHS				MASS kg
	MINIMUM LENGTH A mm	TOL. ON LENGTH	NOM. WIDTH ACROSS FLATS mm	MINIMUM THICKNESS mm	TOL. ON THICKNESS B		C		D		
						min. mm	max. mm	min. mm	max. mm		
15	35		32	8		52	100	150	200	250	0,242
20	37	+ 3mm	37	9	+ 1,5mm	54	100	150	200	250	0,319
25	43		46	9,5		62	100	150	200	250	0,503
32	48		60	11		70	150	200	250	300	0,916
40	48	+ 4,5mm	64	12	+ 4,5mm	71	150	200	250	300	1,029
50	57		78	13		82	150	200	250	300	1,529
65	65		97	17		97	150	200	250	300	2,118
80	71		114	21		106	200	250	300	400	3,507
100	84	+ 6mm	140	22	+ 3mm	121	200	250	300	400	5,182



WROUGHT STEEL FITTINGS

Elbows, Equal Tees and Socket Unions

Screwed BSP thread - Parts 1 & 2

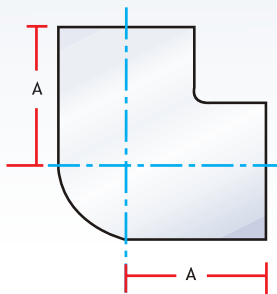

ELBOW

NOMINAL SIZE mm	MINIMUM LENGTH A mm	MINIMUM THICKNESS mm	MASS kg
6	19	3,5	0,03
8	24	3,5	0,04
10	27	3,5	0,07
15	37	4,0	0,10
20	38	4,0	0,14
25	44	4,5	0,17
32	51	5,0	0,30
40	54	5,5	0,41
50	60	6,0	0,64
65	67	6,0	1,00
80	73	7,0	1,62
100	86	7,0	2,30
125	98	7,5	3,35
150	98	8,5	4,45

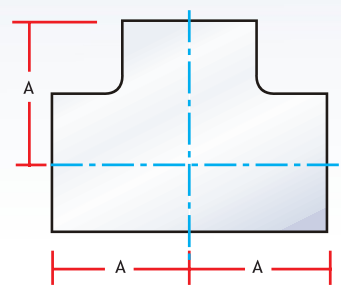

EQUAL TEE

NOMINAL SIZE mm	NOMINAL LENGTH A mm	MASS kg
6	16	0,05
8	22	0,07
10	24	0,11
15	32	0,25
20	35	0,25
25	43	0,41
32	51	0,64
40	52	1,05
50	64	1,68
65	76	2,30
80	89	3,65
100	115	6,77
125	140	10,00
150	160	14,62

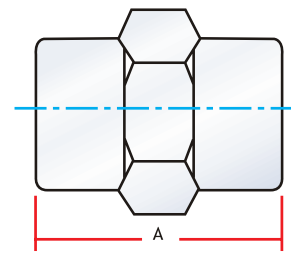

SOCKET UNION

BS 1740 applies to welded and seamless pipe fittings of nominal sizes (6mm to 150mm) inclusive, for use with steel tubes to SABS/SANS 62 screwed BSP thread to ISO 7/1.

Galvanising

Can be supplied galvanised if required.

Screwing

Threads for the screwed ends of fittings comply with the appropriate requirements of BS 21.

Pressure Tests

- An internal hydraulic pressure of 5MN/m²
- An internal hydraulic pressure of 0.7MN/m² while completely immersed in water or light oil.

NOMINAL SIZE mm	MINIMUM LENGTH A mm	MASS kg
6	38	0,09
8	44	0,13
10	51	0,18
15	57	0,25
20	67	0,41
25	76	0,62
32	85	0,91
40	100	1,13
50	110	1,71
65	127	2,30
80	132	4,12
100	175	6,84



WROUGHT STEEL FITTINGS

Reducing and Standard Sockets

Screwed BSP thread - Parts 1 & 2

NOMINAL mm	MASS kg	MINIMUM LENGTH mm	NOMINAL SIZE 1 x 2 mm	MINIMUM LENGTH A mm	MASS kg
8 x 6	0,04	25	50 x 15	70	0,64
			50 X 20	68	0,64
10 x 6	0,06	30	50 x 25	67	0,64
10 x 8	0,06	29	50 x 32	65	0,64
			50 X 40	64	0,64
15 x 6	0,09	41			
15 x 8	0,09	40	65 x 25	76	1,25
15 x 10	0,09	38	65 x 32	75	1,25
			65 x 40	73	1,25
20 x 8	0,12	44	65 X 50	71	1,25
20 x 10	0,12	43			
20 x 15	0,12	41	80 x 25	86	1,98
			80 x 32	84	1,98
25 x 8	0,21	54	80 x 40	83	1,90
25 x 10	0,21	52	80 X 50	81	1,98
25 x 15	0,21	51	80 x 55	79	
25 x 20	0,21	49			
			100 x 40	105	2,90
32 x 10	0,30	60	100 x 50	100	2,90
32 x 15	0,30	59	100 x 55	100	2,90
32 x 20	0,30	57	100 X 80	98	2,90
32 x 25	0,30	56			
			125 x 80	115	4,40
40 x 15	0,40	65	125 x 100	115	4,40
40 x 20	0,40	64			
40 x 25	0,40	62	150 x 80	140	6,10
40 x 32	0,40	60	150 X 100	140	6,10

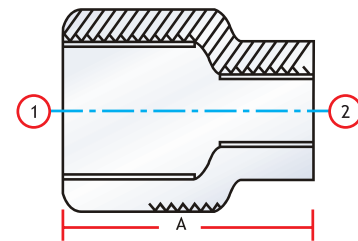

REDUCING SOCKET

NOMINAL SIZE mm	MINIMUM OUTSIDE DIAMETER A mm	MINIMUM LENGTH B mm	MASS kg
6	15,0	19	0,02
8	18,5	27	0,03
10	22,0	28	0,04
15	27,0	37	0,08
20	32,5	39	0,11
25	39,5	46	0,18
32	49,0	51	0,26
40	55,0	51	0,32
50	68,0	60	0,51
65	84,0	69	1,11
80	98,0	75	1,63
100	124,0	87	2,43
125	151,0	96	3,53
150	178,0	96	5,41

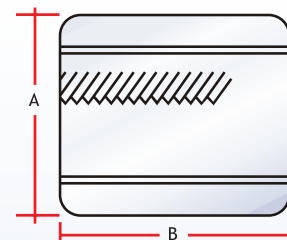

STANDARD SOCKET